

# ADEKA ULTRA SEAL

# KM-3030M

## OCM, Inc.

Sales Information: (847) 955-9700

Technical Information: (800) 999-3959

Contact Local Representative:

### PRODUCT DESCRIPTION:

Size : 30mm X 30mm (1.18" X 1.18")

Packaged: 10m (33 feet) per case - 14kg (31 lbs) /case

Hardness (HS) 28 ± 6 (ASTM D2240)

Tensile Strength: Min 420 psi (ASTM D412)

Elongation (%): Min 550 % (ASTM D412)

Volume Exp.Coefficient: 3 times by volume (150%)

Specific Gravity 1.18 ± 0.15 (ASTM D792)

Vulcanization YES

\*Values based on KM compound

### GENERAL DESCRIPTION

KM-3030M is a chemically modified natural rubber product with an embedded stainless steel wire mesh. A patented process chemically binds a hydrophilic agent to the rubber. The hydrophilic agent causes KM-3030M to undergo controlled expansion in the presence of moisture. This expansion capability provides a "double locking" waterstop. KM-3030M stops water by compression from rubber's natural resilience and by moisture induced expansion. When hydrated, KM-3030M will fill any void within the limits of its expansion capability (150% by volume). KM-3030M is a vulcanized product. Since it is cross linked with sulphur in the vulcanization process, it has high tensile and compressive strength plus good restorability.

KM-3030M has excellent durability and resistance to chemicals. It can perform in a wide range of solutions such as salt or cement water. KM-3030M is environmentally safe. It does not contain any toxic substance or heavy metals.

### BASIC USE:

Use in expansions joints (See Choosing The Right Expansion Joint Product). KM-3030M is an excellent waterstop for use in shear movement joints.

### TYPICAL INSTALLATION

Clean any dirt or loose debris from the surface of the concrete. Adhere KM-3030M by using screws, 3M-2141 rubber adhesive, Bostik ADH 1142M or Hilti 3200 construction adhesive depending on choice and site conditions. If the concrete surface is smooth and dry, 3M-2141, Bostik ADH 1142M or Hilti 3200 CA may be used.

We recommend attaching with screws every 12" (approximately) to ensure attachment. Because of its weight, holding it in position with glue alone may be difficult especially in vertical applications. **(Screws may be left in or removed if KM-3030M is firmly adhered).**

For added assurance or in the case of rough concrete, apply a bead of P-201 before placing KM-3030M. Another option is to place a small bead of P-201 on both sides of the KM-3030M as shown in Detail 3.

### PRECAUTIONS:

Use only where wall or slab thickness is equal to or exceeds 1 foot (12").

Do not allow any gaps between KM-3030M and the concrete. Screw must be perpendicular to the stainless steel wire mesh.

### TYPICAL KM-3030M INSTALLATION

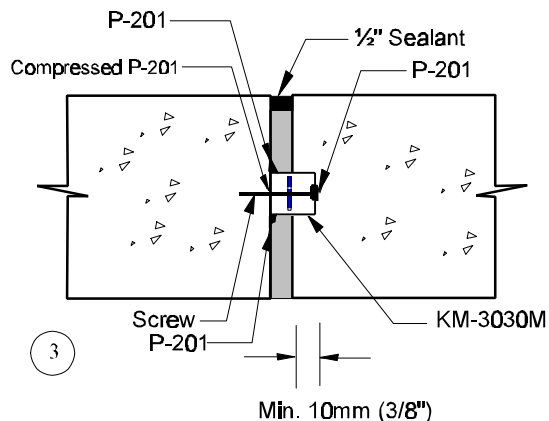
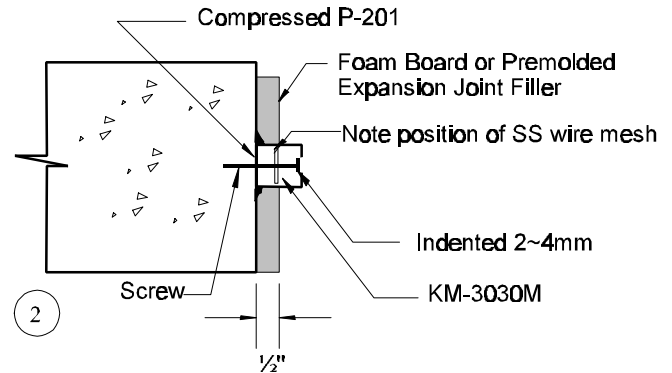
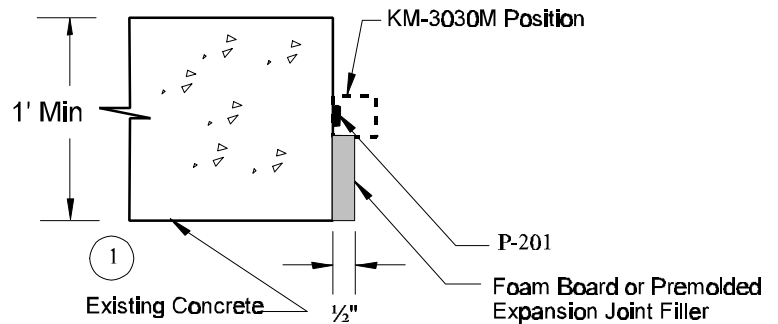

# CHOOSING THE RIGHT EXPANSION JOINT PRODUCT

## KM-3030M OR KM-4040M

**IMPORTANT: "x" must always be a minimum of 10mm (0.40")**

### KM-3030M

Recommend "y" = 0.50" (13mm)

Minimum "x" = 0.40" (10mm)

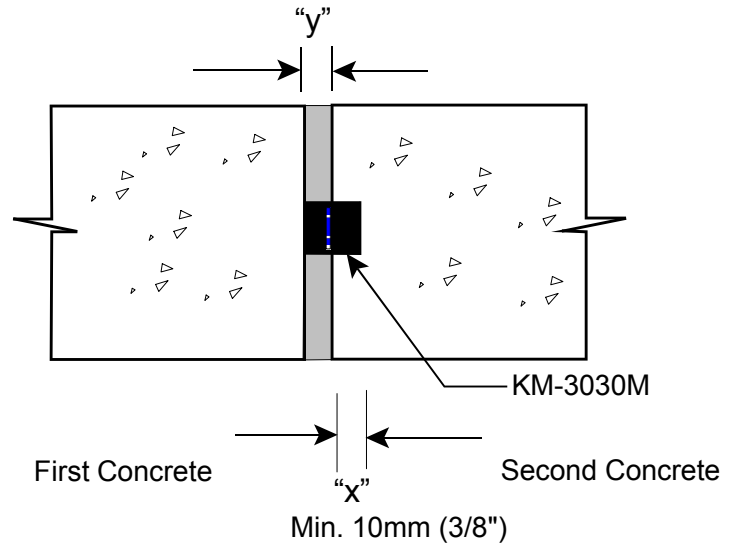

### KM-4040M

Recommend "y" = 0.75" (19 mm)

Minimum "x" = 0.40" (10 mm)

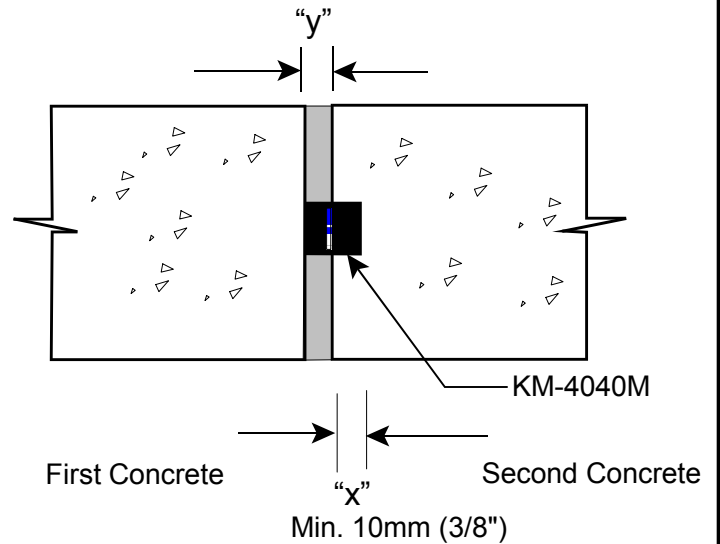

Product	Hydrostatic Head (ft)	Maximum Additional Opening Inches
KM-3003M	20	0.43
	30	0.39
	50	0.34
KM-4040M	20	0.68
	30	0.52
	50	0.46

"Maximum Additional Opening" is the best estimate of ADK. The information is based on the configuration shown above

For More Information:

CALL YOUR LOCAL ADEKA REPRESENTATIVE OR CALL (800) 999-3959