

# ADEKA ULTRA SEAL KM-3030M

## OCM, Inc.

Sales Information: (847) 955-9700  
 Technical Information: (800) 999-3959  
 Contact Local Representative:

### \* PRODUCT DESCRIPTION:

Size : 30mm X 30mm (1.18" X 1.18")

Packaged: 10m (33 feet) per case - 14kg (31 lbs) /case

Hardness (HS) A33 (JIS K 6253) (ASTM D2240)

Tensile Strength MPa: 6 (JIS K 6251) (ASTM D412)

Elongation (%): 800 % (JIS K 6251) (ASTM D412)

Volume Change %: 170 % (In house)

Specific Gravity 1.18 (JIS K 6350) (ASTM D792)

Vulcanization YES

\*Values based on KM compound

\* Property measurements are representative and are not considered as standard values.

### GENERAL DESCRIPTION

KM-3030M is a chemically modified natural rubber product with an embedded stainless steel wire mesh. A patented process chemically binds a hydrophilic agent to the rubber. The hydrophilic agent causes KM-3030M to undergo controlled expansion in the presence of moisture. This expansion capability provides a "double locking" waterstop. KM-3030M stops water by compression from rubber's natural resilience and by moisture induced expansion. When hydrated, KM-3030M will fill any void within the limits of its expansion capability (150% by volume). KM-3030M is a vulcanized product. Since it is cross linked with sulphur in the vulcanization process, it has high tensile and compressive strength plus good restorability.

KM-3030M has excellent durability and resistance to chemicals. It can perform in a wide range of solutions such as salt or cement water. KM-3030M is environmentally safe. It does not contain any toxic substance or heavy metals.

### BASIC USE:

Use in expansion joints (See Choosing The Right Expansion Joint Product). KM-3030M is an excellent waterstop for use in shear movement joints.

### TYPICAL INSTALLATION

Clean any dirt or loose debris from the surface of the concrete. Adhere KM-3030M by using screws, 3M-2141 rubber adhesive, Bostik ADH 1142M or Hilti 3200 construction adhesive depending on choice and site conditions. If the concrete surface is smooth and dry, 3M-2141, Bostik ADH 1142M or Hilti 3200 CA may be used.

We recommend attaching with screws every 12" (approximately) to ensure attachment. Because of its weight, holding it in position with glue alone may be difficult especially in vertical applications. **(Screws may be left in or removed if KM-3030M is firmly adhered).**

For added assurance or in the case of rough concrete, apply a bead of P-201 before placing KM-3030M. Another option is to place a small bead of P-201 on both sides of the KM-3030M as shown in Detail 3.

### PRECAUTIONS:

Use only where wall or slab thickness is equal to or exceeds 1 foot (12").

### TYPICAL KM-3030M INSTALLATION

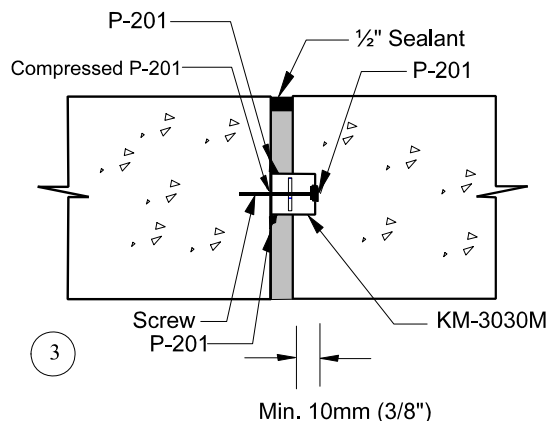
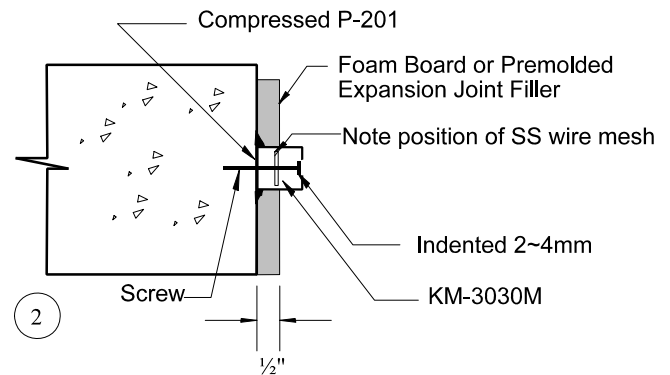
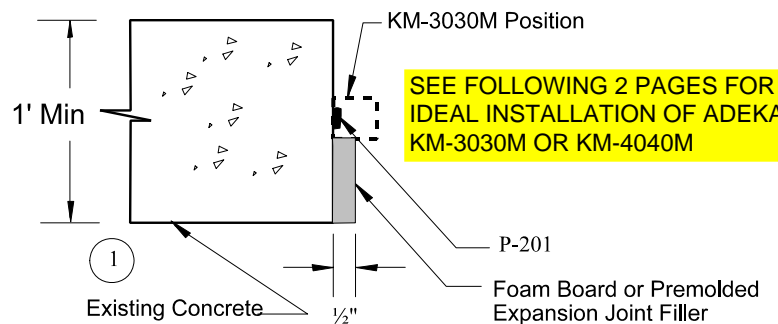

# Recommended KM-3030M Installation

## For Minimum 12" Wall/Slab Expansion Joint

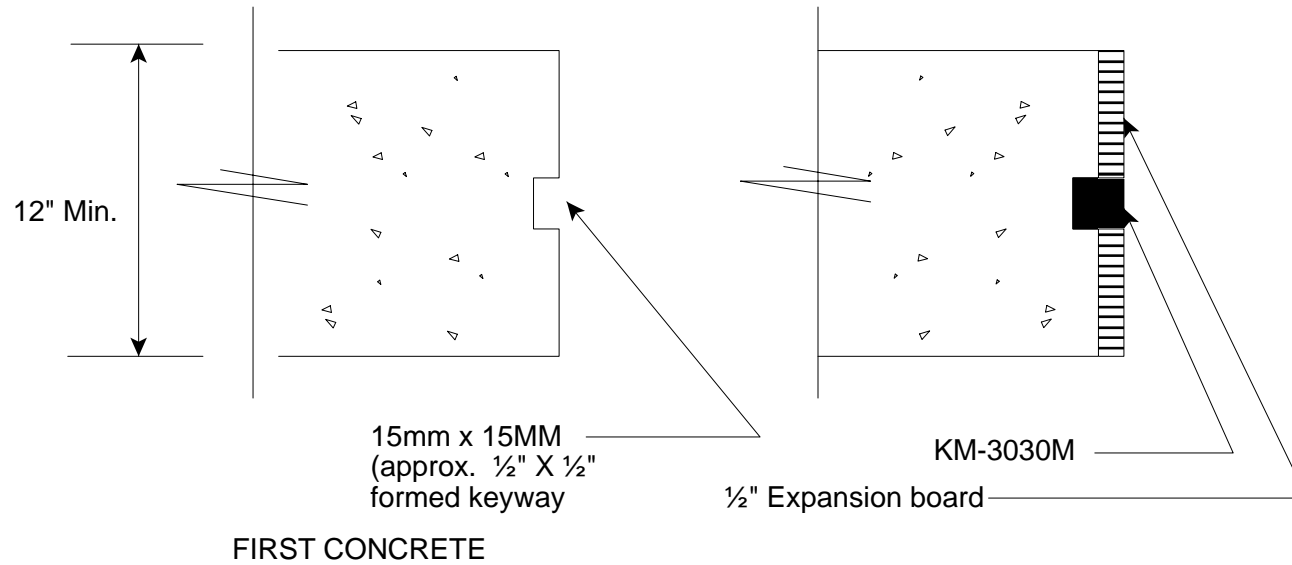

Check with your local representative for complete installation details for this procedure.

For more information call:  
800.999.3959

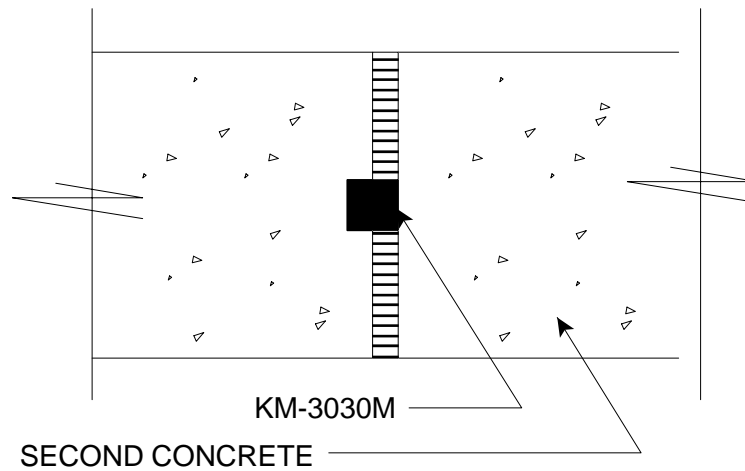

## Ideal Installation ADEKA ULTRA SEAL KM-3030M or KM-4040M

### STORAGE:

Store in cool dry place. Protect from any exposure to moisture

### INSTALLATION INSTRUCTIONS:

#### Place Concrete

1. Level Concrete
2. Prepare form for keyway - note dimensions
3. Form Keyway - Note dimensions depending on if KM-3030M or KM-4040M.

\* 4. Apply 5mm X 12mm bead of P-201 (approximate). One 320 ml cartridge will cover approximately 5.3 meters at this bead size.

\* Step 4 is the ideal installation procedure. P-201 will help hold the KM-3030M (KM-4040M) in place and prevent concrete fines from penetrating between the KM-3030M (KM-4040M) and the concrete. If the KM-3030M (KM-4040M) fits tightly and the concrete is smooth, P-201 may not be necessary in this area.

**IMPORTANT: DO NOT ALLOW ANY GAPS BETWEEN THE CONCRETE AND THE KM-3030M or KM-4040M. USE FLAT HEAD SCREWS TO HOLD KM- FIRMLY IN PLACE WHERE EVER NECESSARY.**

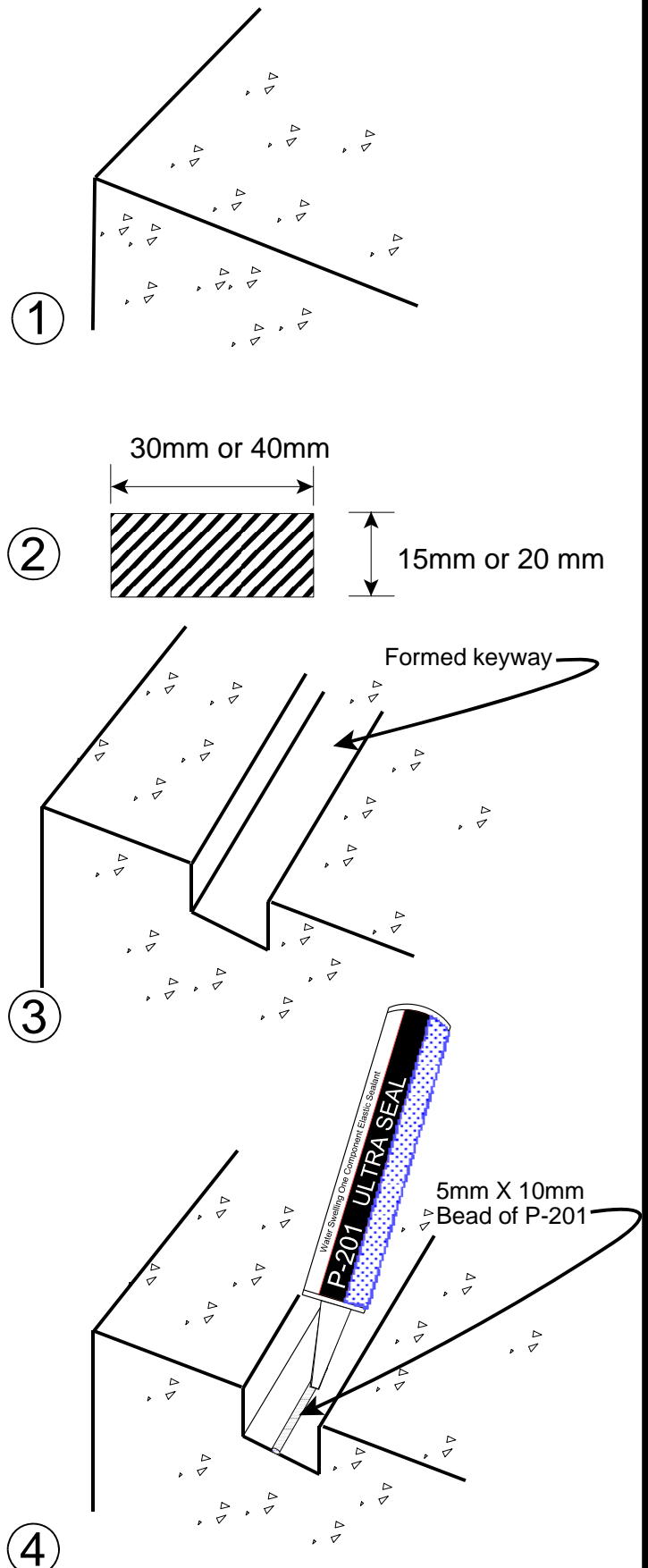

# ADEKA ULTRA SEAL KM-3030M (KM-4040M)

## INSTALLATION INSTRUCTIONS CONTINUED:

5. Note position of stainless steel mesh.

**IMPORTANT - MESH MUST BE PARALLEL TO THE FACE OF THE CONCRETE AS SHOWN.**

*Wire mesh shown for illustration purposes only. **THE MESH MAY NOT BE VISIBLE** in the actual product. Bend the material to determine the position of the wire mesh. When the wire mesh is parallel, it will bend easily. If it is in the wrong position, bending will be more difficult. Place the product so the wire mesh is in the position shown.*

6. Butt Joints: Apply P-201 around the perimeter of the KM-3030M (KM-4040M).

**IMPORTANT - DO NOT ALLOW ANY GAPS BETWEEN SEGMENTS OF KM-3030M (KM-4040M). FOR ADDED SAFETY, APPLY SMALL BEAD OF P-201 ON TOP OF BUTT JOINT.**

7. Apply small bead of P-201 at the intersection of the KM-3030M (KM-4040M) and the concrete. Apply to both sides of the concrete.

**IMPORTANT - APPLYING P-201 IN THIS AREA IS ESSENTIAL. P-201 MUST COMPLETELY COVER THE INTERSECTION OF KM-3030M (KM-4040M) AND THE CONCRETE.**

**5mm X 5mm  
P-201**

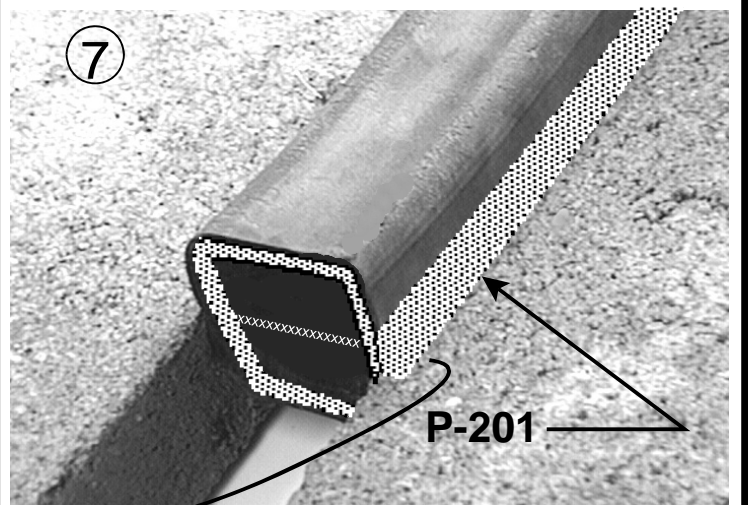
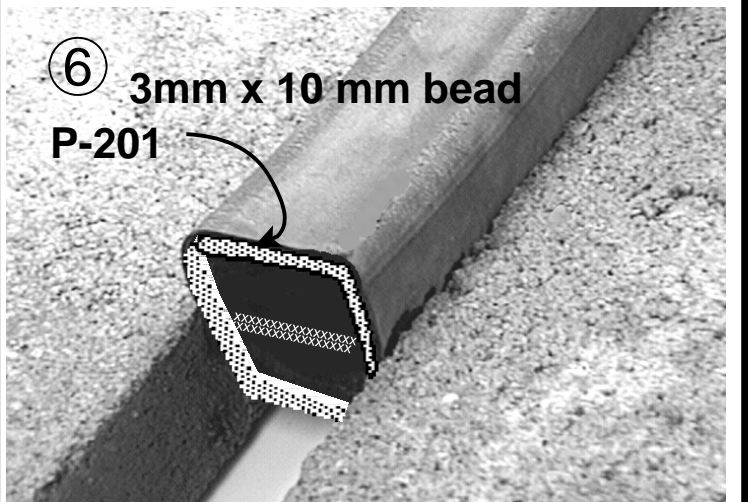
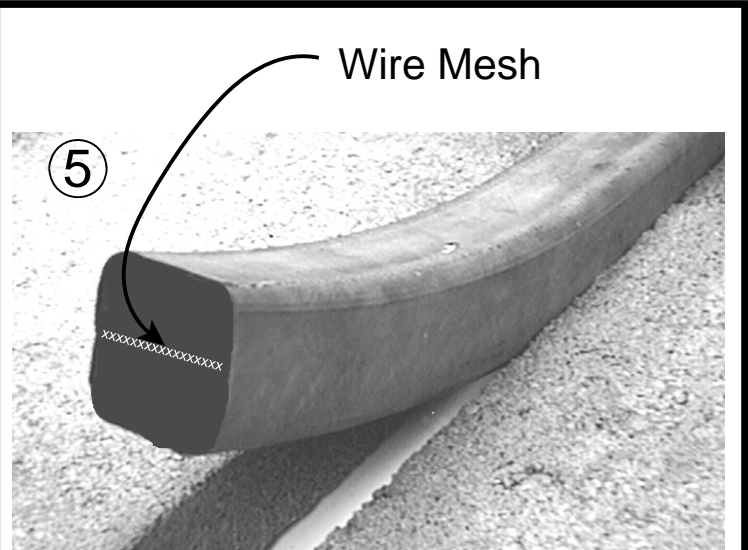
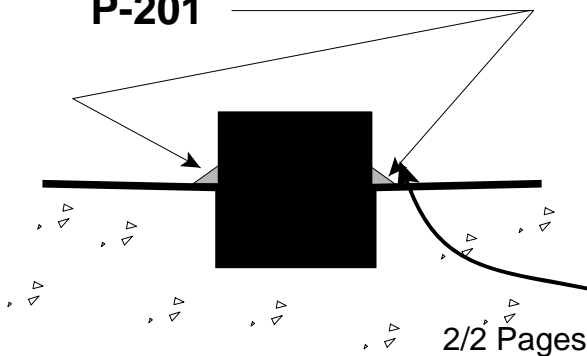

# CHOOSING THE RIGHT EXPANSION JOINT PRODUCT

## KM-3030M OR KM-4040M

**IMPORTANT: "x" must always be a minimum of 10mm (0.40")**

### KM-3030M

Recommend "y" = 0.50" (13mm)

Minimum "x" = 0.40" (10mm)

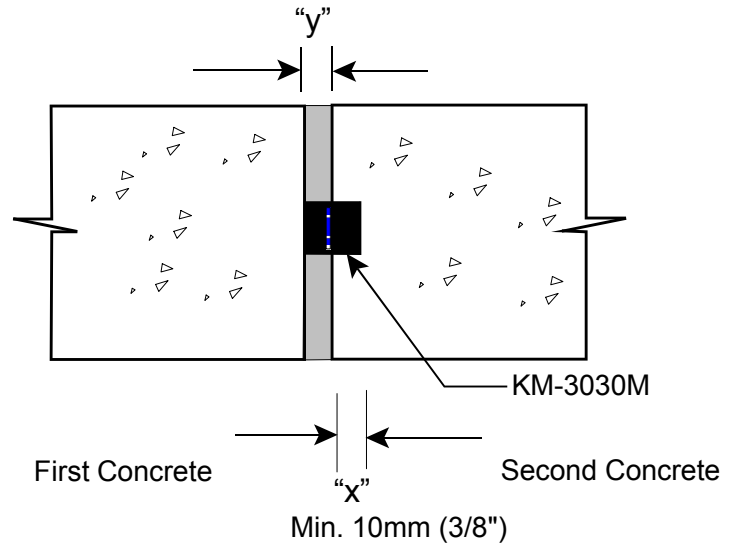

### KM-4040M

Recommend "y" = 0.75" (19 mm)

Minimum "x" = 0.40" (10 mm )

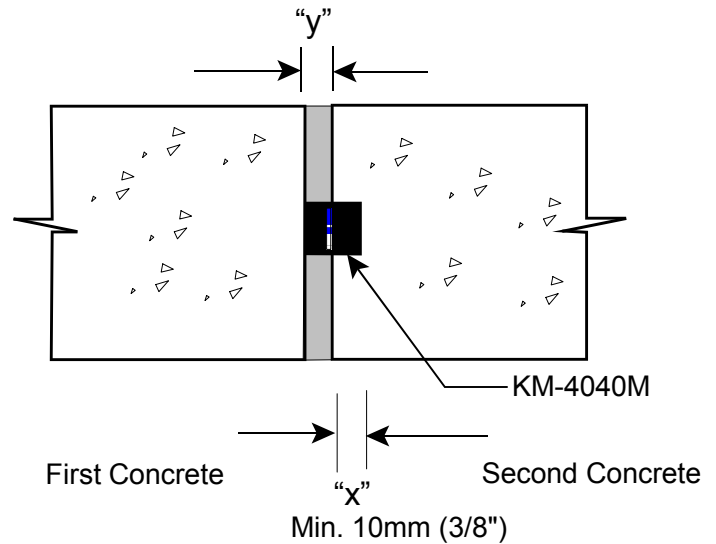

Product	Hydrostatic Head (ft)	Maximum Additional Opening Inches
KM-3030M	20	0.43
	30	0.39
	50	0.34
KM-4040M	20	0.68
	30	0.52
	50	0.46

"Maximum Additional Opening" is the best estimate of ADK. The information is based on the configuration shown above

For More Information:  
CALL YOUR LOCAL ADEKA REPRESENTATIVE OR CALL (800) 999-3959